

# Situacija zahvata prije revitalizacije 2

---

**Krajačić, Boris**

## Supplement / Prilog

Publication year / Godina izdavanja: **2021**

Permanent link / Trajna poveznica: <https://urn.nsk.hr/urn:nbn:hr:157:953077>

Rights / Prava: [Attribution 4.0 International](#)/[Imenovanje 4.0 međunarodna](#)

Download date / Datum preuzimanja: **2025-04-03**



Repository / Repozitorij:

[Repository of the University of Rijeka, Faculty of Civil Engineering - FCERI Repository](#)



DETALJNA SITUACIJA  
od km 0+000,00 do km 0+462,70

M 1:500

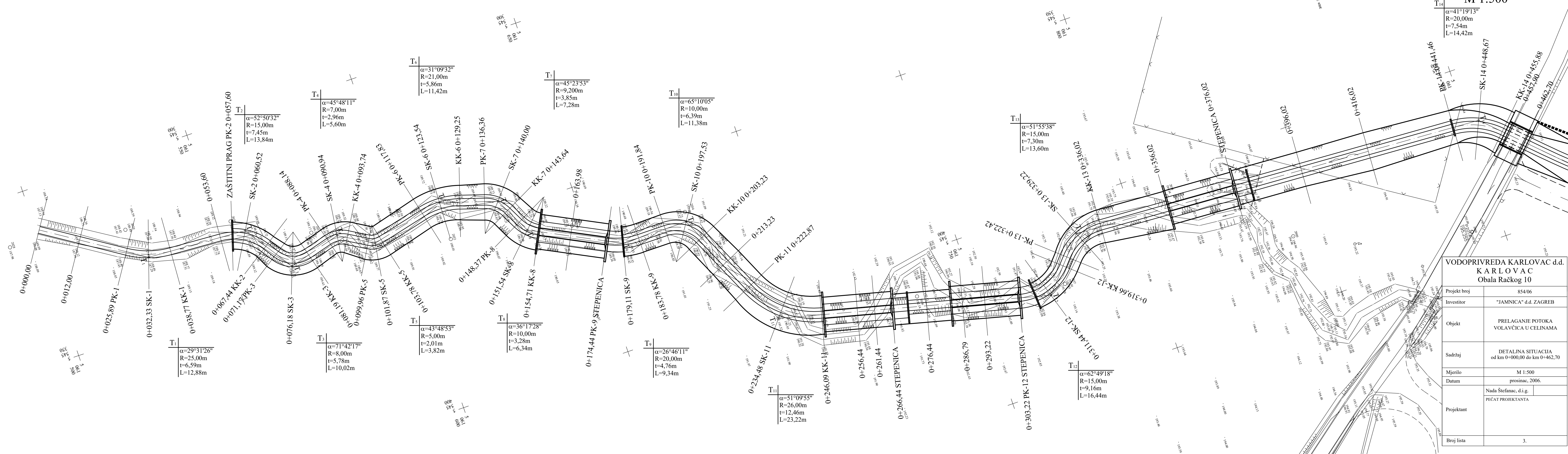

T14	$\alpha=41^{\circ}19'13''$ R=20,00m t=7,54m L=14,42m
-----	---

T2	$\alpha=52^{\circ}50'32''$ R=15,00m t=7,45m L=13,84m
----	---

T4	$\alpha=45^{\circ}48'11''$ R=7,00m t=2,96m L=5,60m
----	---

T6	$\alpha=31^{\circ}09'32''$ R=21,00m t=5,86m L=11,42m
----	---

T7	$\alpha=45^{\circ}23'53''$ R=9,200m t=3,85m L=7,28m
----	--

T10	$\alpha=65^{\circ}10'05''$ R=10,00m t=6,39m L=11,38m
-----	---

T11	$\alpha=51^{\circ}55'38''$ R=15,00m t=7,30m L=13,60m
-----	---

T1	$\alpha=29^{\circ}31'26''$ R=25,00m t=6,59m L=12,88m
----	---

T3	$\alpha=71^{\circ}42'17''$ R=8,00m t=5,78m L=10,02m
----	--

T5	$\alpha=43^{\circ}48'53''$ R=5,00m t=2,01m L=3,82m
----	---

T8	$\alpha=36^{\circ}17'28''$ R=10,00m t=3,28m L=6,34m
----	--

T9	$\alpha=26^{\circ}46'11''$ R=20,00m t=4,76m L=9,34m
----	--

T11	$\alpha=51^{\circ}09'55''$ R=26,00m t=12,46m L=23,22m
-----	--

T12	$\alpha=62^{\circ}49'18''$ R=15,00m t=9,16m L=16,44m
-----	---

VODOPRIVREDA KARLOVAC d.d. KARLOVAC Obala Račkog 10	
Projekt broj	854/06
Investitor	"JAMNICA" d.d. ZAGREB
Objekt	PRELAGANJE POTOKA VOLAVČICA U CELINAMA
Sadržaj	DETALJNA SITUACIJA od km 0+000,00 do km 0+462,70
Mjerilo	M 1:500
Datum	prosinac, 2006.
Projektant	Nada Štefanac, d.i.g. PEČAT PROJEKTANTA
Broj lista	3.